



3855 North Ocoee Street, Suite 200  
Cleveland, TN 37312

SENT BY FEDERAL EXPRESS

March 22, 2011

Mr. Patrick Bowe  
Remediation Division  
Bureau of Water Protection and Land Reuse  
State of Connecticut Department of Environmental Protection  
79 Elm Street  
Hartford, CT 06106

Re: Property-Specific Remedial Action Report  
Newhall Street Neighborhood  
98 Morse Street  
Hamden, Connecticut 06517

Dear Mr. Bowe:

Enclosed is the Property-Specific Remedial Action Report (RAR) prepared for the property located at 98 Morse Street in Hamden, Connecticut. The Property-Specific RAR summarizes the remediation and restoration activities conducted at the property as required by Consent Order No. SRD-128. Remediation and restoration for this property is complete and has been implemented in compliance with the Remedy Selection Plan and the Generic RAP approved by the Connecticut Department of Environmental Protection (CTDEP).

Section 2.0 of the RAR documents property-specific construction activities, as well as any adjustments to the Property-Specific Remedial Action Plan (RAP) that were required due to the extent of fill encountered or other field conditions. Please note that any field adjustments made were pursuant to the approved Generic RAP and/or with CTDEP oversight and approval. Olin hereby submits this Property-Specific RAR for CTDEP approval.

Please contact me at (423) 336-4540 if you have any questions regarding this matter.

Sincerely,  
OLIN CORPORATION

A handwritten signature in black ink, appearing to read "David M. Share".

David M. Share  
Director, Environmental Remediation

cc: Ms. Leila Davis – 98 Morse Street, Hamden, Connecticut 06517  
Curt Richards – Olin  
Carrie Hunt – Olin  
Nelson Walter – MACTEC  
Robert Bell – CTDEP  
Ray Frigon – CTDEP  
Richard Pearce – Newhall Street Neighborhood Community Liaison

**PROPERTY-SPECIFIC REMEDIAL ACTION REPORT  
98 MORSE STREET**

**NON-PUBLIC PROPERTIES  
NEWHALL STREET NEIGHBORHOOD  
HAMDEN, CONNECTICUT**

**Prepared for:**

**Olin Corporation**  
Cleveland, Tennessee

**Prepared by:**



**MACTEC Engineering and Consulting, Inc.**  
1090 Elm Street, Suite 201  
Rocky Hill, Connecticut 06067

**March 22, 2011**

**PROPERTY-SPECIFIC REMEDIAL ACTION REPORT  
98 MORSE STREET**

**NON-PUBLIC PROPERTIES  
NEWHALL STREET NEIGHBORHOOD  
HAMDEN, CONNECTICUT**

Prepared for:

Olin Corporation  
Cleveland, Tennessee

Prepared by:



MACTEC Engineering and Consulting, Inc.  
1090 Elm Street, Suite 201  
Rocky Hill, Connecticut 06067

March 22, 2011

MACTEC Project No.: 6107110004-55

A handwritten signature in black ink that reads "Nelson Walter". To the left of the signature is a small green graphic consisting of three overlapping rectangular blocks, similar to the MACTEC logo.

**MACTEC Electronic Signature**

---

Nelson Walter, P.E.  
Project Manager

A handwritten signature in black ink that reads "Rod Pendleton". To the left of the signature is a small green graphic consisting of three overlapping rectangular blocks, similar to the MACTEC logo.

**MACTEC Electronic Signature**

---

Rod Pendleton, P.G.  
Principal Scientist

## DOCUMENT CERTIFICATION

I have personally examined and am familiar with the information submitted in this document and all attachments thereto, and I certify, based on reasonable investigation, including my inquiry of those individuals responsible for obtaining the information, that the submitted information is true, accurate and complete to the best of my knowledge and belief. I understand that any false statement made in the submitted information is punishable as a criminal offense under §53a-157b of the Connecticut General Statutes and any other applicable law.

David M. Share, Director, Environmental Remediation

  
\_\_\_\_\_  
Chief Executive Officer (or duly authorized representative)  
Olin Corporation

## DOCUMENT CERTIFICATION

I have personally examined and am familiar with the information submitted in this document and all attachments thereto, and I certify, based on reasonable investigation, including my inquiry of those individuals responsible for obtaining the information, that the submitted information is true, accurate and complete to the best of my knowledge and belief. I understand that any false statement made in the submitted information is punishable as a criminal offense under §53a-157b of the Connecticut General Statutes and any other applicable law.

Nelson Walter, Project Manager



---

MACTEC Engineering and Consulting, Inc.

## TABLE OF CONTENTS

<b>1.0</b>	<b>INTRODUCTION .....</b>	<b>1-1</b>
1.1	REGULATORY STATUS .....	1-1
1.2	DESCRIPTION OF REMEDY PROCESS .....	1-1
<b>2.0</b>	<b>PROPERTY-SPECIFIC CONSTRUCTION ACTIVITIES .....</b>	<b>2-1</b>
<b>3.0</b>	<b>REFERENCES .....</b>	<b>3-1</b>

### FIGURES

Figure 2-1 Post-Construction Conditions

### TABLES

Table 2-1 Excavation Confirmation XRF Sampling Results

### ATTACHMENTS

Attachment A Photographs

### LIST OF ACRONYMS AND ABBREVIATIONS

bgs	below ground surface
CTDEP	Connecticut Department of Environmental Protection
MACTEC	MACTEC Engineering and Consulting, Inc.
NPP	non-public properties
Olin	Olin Corporation
RAP	Remedial Action Plan
RAR	Remedial Action Report
RSP	Remedy Selection Plan
XRF	X-ray fluorescence

## **1.0 INTRODUCTION**

This Property-Specific Remedial Action Report (RAR) was prepared by MACTEC Engineering and Consulting, Inc. (MACTEC) on behalf of Olin Corporation (Olin) for the property located at 98 Morse Street in Hamden, Connecticut. This Property-Specific RAR was prepared based on information obtained during remediation activities conducted at the property during the 2010 construction season. This document provides information about the remediation activities completed for the property, which are required by Consent Order SRD-128 entered into by Olin, the Town of Hamden, the Regional Water Authority, the State Board of Education, and the State of Connecticut Department of Environmental Protection (CTDEP). The Consent Order requires Olin to excavate and remove fill material up to 4 feet below ground surface (bgs) from approximately 230 residential properties within the Consent Order boundary.

Section 1 of this report provides a summary of site history and a general description of the remedy process for the Newhall Street Neighborhood. Section 2 of this report describes the construction activities conducted at 98 Morse Street.

### **1.1 REGULATORY STATUS**

In April 2003, the CTDEP issued a Consent Order to Olin, the Town of Hamden, South Central Connecticut Regional Water Authority, and the State Board of Education (CTDEP, 2003). The Consent Order requires Olin to investigate and remediate the Non-Public Properties (NPP) within the Consent Order boundary of the Newhall Street Neighborhood.

### **1.2 DESCRIPTION OF REMEDY PROCESS**

In October 2007, a Final Remedy Selection Plan (RSP) was approved and issued by the Commissioner of the CTDEP (CTDEP, 2007). The remedy for the NPP within the Consent Order boundary is summarized below:

- Excavation of fill within the top 4 feet;
- Disposition of excavated material at authorized off-site facilities;
- Backfilling of excavated areas with clean soil; and
- Restoration of existing features including landscaping, patios, fencing, driveways, etc. that are disturbed during construction activities.

The Final Design - Generic Remedial Action Plan (RAP) (MACTEC, 2008), was approved by the CTDEP and serves as the basis for remedial action activities within the NPP. The Final Design - Generic RAP details remedial construction activities including excavation of fill to a depth of up to four feet, backfilling excavations, disposition of fill and debris, and restoration of disturbed areas. Detailed plans and specifications regarding the remediation are contained in the Generic RAP and other project plans which have been approved by the CTDEP. The Final Design - Generic RAP and other plans are available at the Town of Hamden Miller Public Library located at 290 Dixwell Avenue, and on the CTDEP website at: <http://www.newhallinfo.org>.

The Final Design-General RAP requires that prior to implementing the approved remedial solution, a Property-Specific RAP be prepared for each property owner and submitted to the CTDEP for approval. The purpose of the Property-Specific RAP is to provide the homeowner with information regarding the planned construction activities, temporary relocation requirements (if necessary), access provisions, an estimated time table to complete the planned work, and a description of plans to restore the property to existing conditions.



## **2.0 PROPERTY-SPECIFIC CONSTRUCTION ACTIVITIES**

During the 2010 construction season, Olin completed the excavation of fill material to a depth of 4 feet bgs, backfill, and restoration of the property in accordance with the Final Design - Generic RAP and the Property-Specific RAP. Figure 2-1 shows the areas where excavation occurred on the property and the locations of excavation confirmation samples. Excavation confirmation samples were collected in accordance with Section 3.2.3 – Confirmatory Sampling of the Final Design - Generic RAP, including adherence to the sampling frequency requirements. X-ray fluorescence (XRF) excavation confirmation sampling results are presented in Table 2-1. As indicated in Table 2-1, all confirmation sampling results, indicate total lead concentrations less than the criteria of 400 mg/kg approved by CTDEP in the Final Design - Generic RAP.

The following is a description of changes from the Property-Specific RAP that were necessitated because of field conditions:

- Additional fill material was located on the property outside of the originally expected areas presented in the Property-Specific RAP and the Final Design - Generic RAP.
- All fill material within 4 feet of ground surface was removed in accordance with the Property-Specific RAP and the Final Design - Generic RAP, with the exception of areas adjacent to the front and side entrances to the house. Removal of additional fill from these areas would have resulted in undermining the steps. The fill material was covered with an orange geotextile marker barrier prior to backfilling with clean soil, in accordance with the Final Design - Generic RAP. The approximate limits of the orange geotextile marker barrier are presented on Figure 2-1.

Photographs of construction activities and the restored property are presented in Attachment A.

### **3.0 REFERENCES**

- CTDEP, 2003. Order No. SRD-128, State Of Connecticut vs. Town Of Hamden, South Central Connecticut Regional Water Authority, State Board Of Education, and Olin Corporation. State of Connecticut Department of Environmental Protection, April 16, 2003.
- CTDEP, 2007. Remedy Selection Plan, Newhall Street, Neighborhood Remediation Project. State of Connecticut Department of Environmental Protection, October 2007
- MACTEC, 2008. Final Design - Generic Remedial Action Plan, Non-Public Properties, Newhall Street Neighborhood, Hamden, Connecticut. MACTEC Engineering and Consulting, Inc., August 19, 2008.
- MACTEC, 2009. Property-Specific Remedial Action Plan, 98 Morse Street, Non-Public Properties, Newhall Street Neighborhood, Hamden, Connecticut. MACTEC Engineering and Consulting, Inc., October 2, 2009.

## **FIGURES**

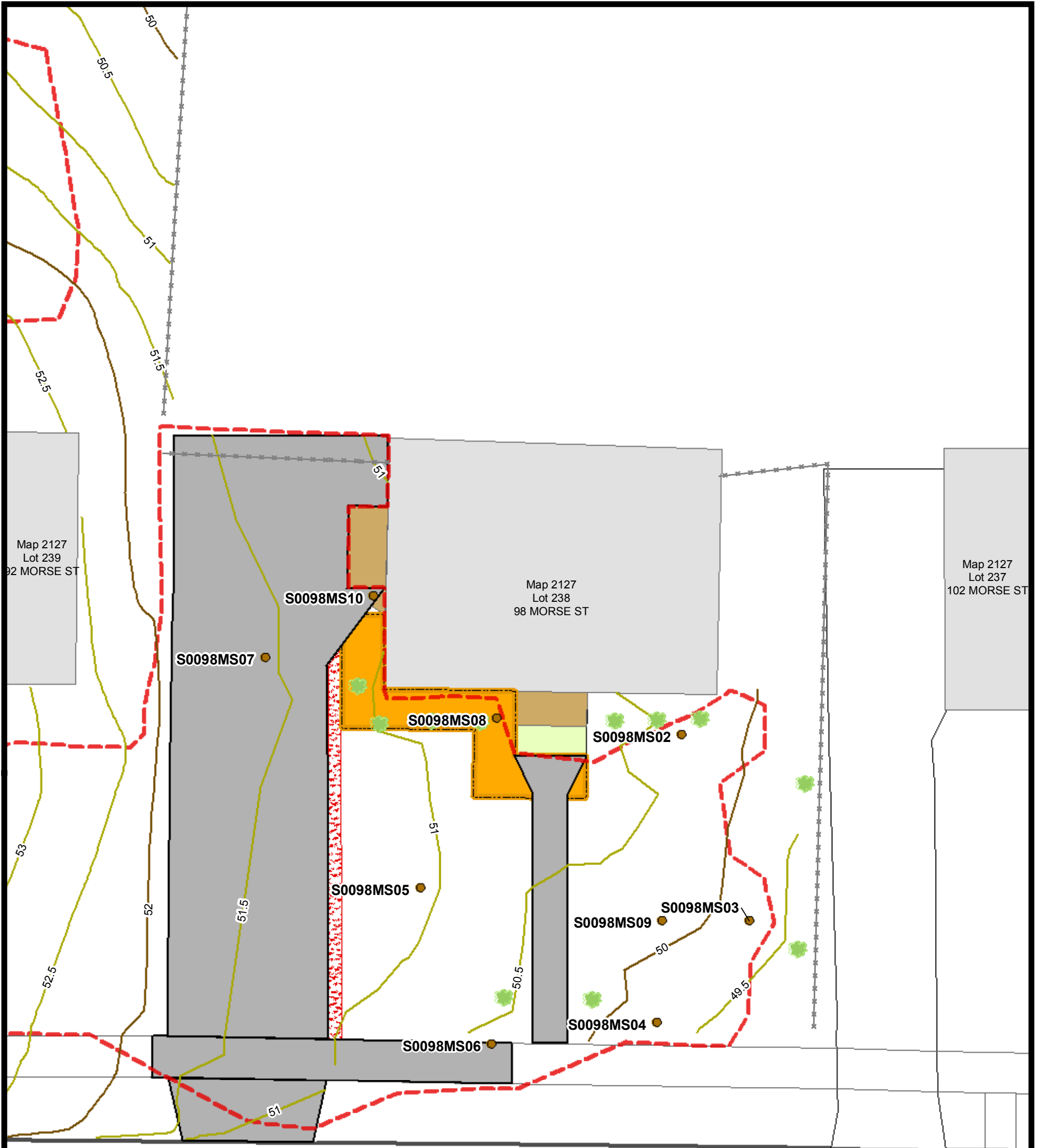

**Morse Street**

**Legend**

- |   |            |           |                                |
|---|------------|-----------|--------------------------------|
| Approximate Extent of Orange Marker Barrier | Stairs     | New Shrub | New Asphalt Driveway/Sidewalk  |
| Excavation Confirmation Sample              | Porch      | New Tree  | New Concrete Driveway/Sidewalk |
| Limits of Excavation                        | Bark Mulch |           |                                |
| Final Elevation Contour (2-ft interval)     |            |           |                                |
| Final Elevation Contour (0.5-ft interval)   |            |           |                                |

Note: All grass areas disturbed by excavation were restored with sod and/or seed/mulch.



0 5 10 Feet

Prepared/Date: CHL 02/01/11  
Checked/Date: DRP 02/01/11

**TABLES**

**TABLE 2-1  
EXCAVATION CONFIRMATION XRF SAMPLING RESULTS**

**98 MORSE STREET - NEWHALL STREET NEIGHBORHOOD  
HAMDEN, CONNECTICUT**

Location ID	Location Type	Field Sample ID	Sample Date	Top Depth (ft,bgs)	Bottom Depth (ft,bgs)	Parameter	Result	Final Qualifier	Unit of Measure
S0098MS02	PES	S0098MS-SON0201EX	25-Aug-10	1	1	Lead	254		MG/KG
S0098MS03	PES	S0098MS-SON0301EX	25-Aug-10	1	1	Lead	124		MG/KG
S0098MS04	PES	S0098MS-SON0401EX	25-Aug-10	1	1	Lead	50	U	MG/KG
S0098MS05	PEB	S0098MS-SON0502EX	26-Aug-10	2	2	Lead	50	U	MG/KG
S0098MS06	PES	S0098MS-SON0601EX	26-Aug-10	1	1	Lead	50	U	MG/KG
S0098MS07	PES	S0098MS-SON0701EX	26-Aug-10	1	1	Lead	50	U	MG/KG
S0098MS08	PES (a)	S0098MS-SON0802EX	26-Aug-10	2	2	Lead	337		MG/KG
S0098MS09	PEB	S0098MS-SON0902EX	25-Aug-10	2	2	Lead	50	U	MG/KG
S0098MS10	PES (a)	S0098MS-SON1002EX	26-Aug-10	2	2	Lead	50	U	MG/KG

Notes: (a) - Results from a sample of fill material remaining on the property in accordance with the Final Design-Generic RAP (MACTEC, 2008)

bgs - below ground surface

ft - feet

KG - kilograms

MG - milligrams

PEB - sample from bottom of excavation

PES - sample from perimeter of excavation

U - not detected at a concentration above the reporting limit

XRF - x-ray fluorescence

**ATTACHMENT A**

**PHOTOGRAPHS**



**View looking southeast at excavation in front yard.**



**View looking southwest at at excavation in front yard following placement of marker barrier.**





**View looking south across Morse Street at property backfilled and prepped for restoration.**



**View looking south across Morse Street at restored property.**